



# LIGHTLE COMMERCIAL

◀ INCORPORATED ▶

COMMERCIAL REAL ESTATE SERVICES

*Leaders By Performance*

## OFFICE FOR LEASE

Melbourne, FL

**2287 W. Eau Gallie Blvd., Suite B  
Melbourne, FL**



**ROB BECKNER,**

*PARTNER*

(321) 722-0707 EXT. 11

rob@lightlecommercial.com

www.lightlecommercial.com

**1398 S. BABCOCK ST.  
MELBOURNE, FL 32901  
FAX (321) 722-0581**

<b>AVAILABILITY:</b>	1,980± sf - Suite B
<b>PRICE:</b>	\$15.00/sf Gross (includes CAM, Ins. & RE Taxes)
<b>IMPROVEMENT:</b>	Built out with offices, waiting area, men's and women's restrooms.
<b>COMMENTS:</b>	Located directly on Eau Gallie Blvd. between US 1 and Wickham Rd., about 5 minutes to I-95. Office space is ready to move into.
<b>CONTACT:</b>	Rob Beckner, Partner 321-722-0707 x 11 Rob@lightlecommercial.com

Information contained herein has been obtained from others and considered to be reliable; however, a prospective purchaser or lessee is expected to verify all information to his/her own satisfaction.

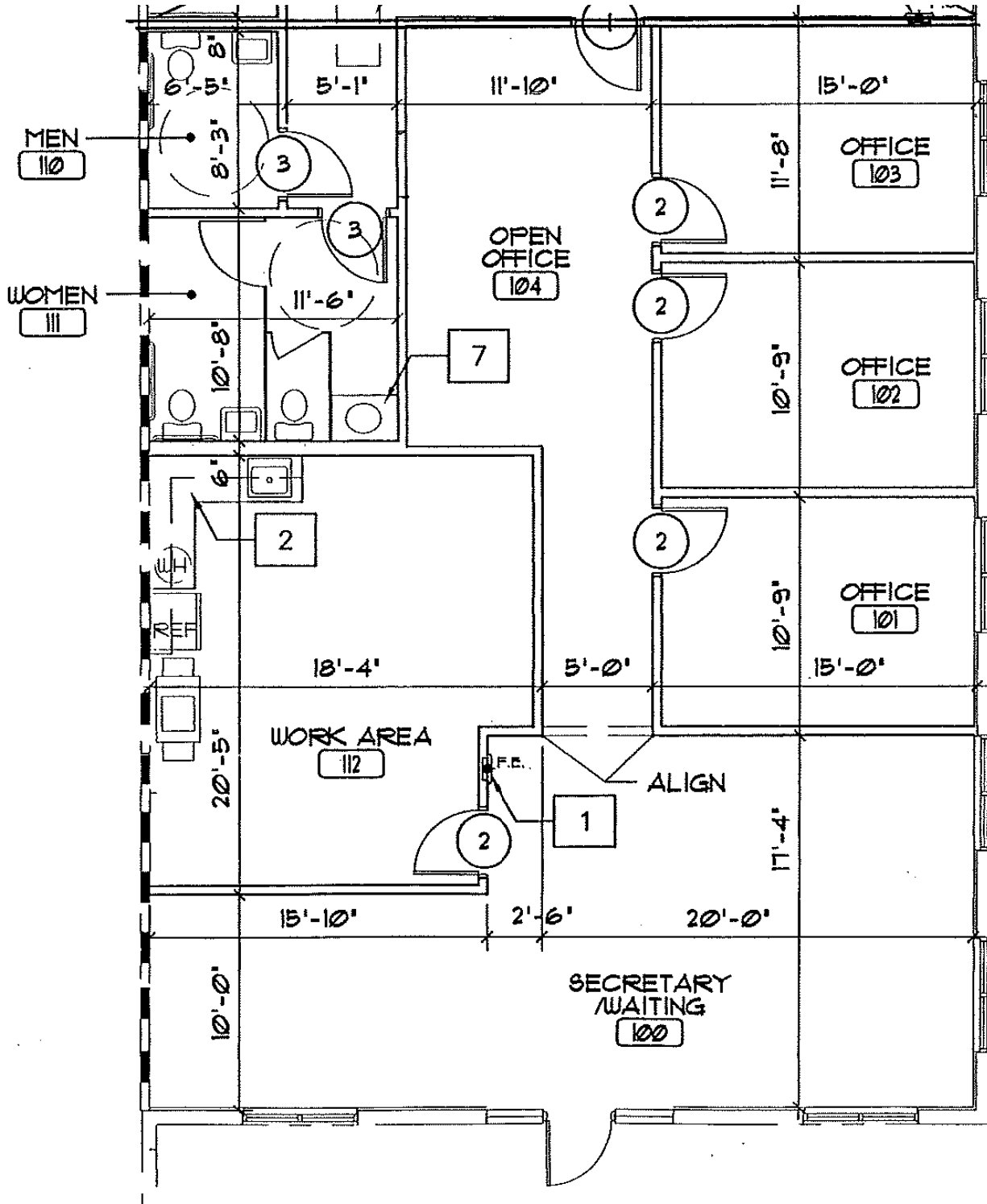

**ROB BECKNER, PARTNER**

**CALL (321) 863-3226**

[rob@lightlecommercial.com](mailto:rob@lightlecommercial.com)



**LIGHTLE COMMERCIAL**

INCORPORATED

COMMERCIAL REAL ESTATE SERVICES

1398 S. BABCOCK ST. • MELBOURNE, FL 32901  
 (321) 722-0707 • FAX (321) 722-0581

*Information contained herein has been obtained from others and considered to be reliable; however, a prospective purchaser or lessee is expected to verify all information to his/her own satisfaction.*